

Part Number	HM518445-HM518410
Series	HM518400
System of Measurement	Inch
Type	Bearing
Cone Part Number	HM518445
Cup Part Number	HM518410
Bearing Weight	6.1 lb
Cage Material	Stamped Steel
Bore(d)	3.5"
Cup Outer Diameter(D)	6"
Cone Width(B)	1.5625"
Cup Width(C)	1.1875"
Bearing Width(T)	1.5625"
Cone Backface ToClear Radius(R)	0.25"
Cup Backface ToClear Radius(r)	0.130"
Cone Frontface Backing Diameter(Da)	4.63"
Cone Backface Backing Diameter(Db)	4.41"
Cup Frontface Backing Diameter(Da)	5.83"
Cup Backface Backing Diameter(Db)	5.39"
Cage Cone Frontface Clearance(Aa)	0.16"
Cage Cone Backface Clearance(Aa)	0.11"
Effective Center Location(a)	-0.25"
Dynamic Radial Rating(90 million revolutions)(C90)	17300 lbf
Dynamic Radial Rating(1 million revolutions)(C1)	66700 lbf
Static Radial Rating(C0)	90800 lbf
Dynamic Thrust Rating(90 million revolutions)(Ca90)	11900 lbf
Factor(K)	1.45
ISO Factor(w)	0.4
ISO Factor(Y)	1.49
Heat Generation Factor (Roller Raceway)(G1)	162
Heat Generation Factor (Rib Roller End)(G2)	33.7
Geometry Factor(Cg)	0.0966

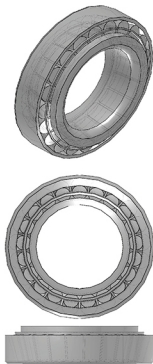

This bearing print is for displaying on www.clibearings.com ONLY!

PART
NO.

TS Series

HM518445-HM518410

CLI BEARINGS CO., LTD.

www.clibearings.com sales@clibearings.com

