

One Way Clutch Bearing

Part Number: **RC-040708-FS** with stainless steel springs

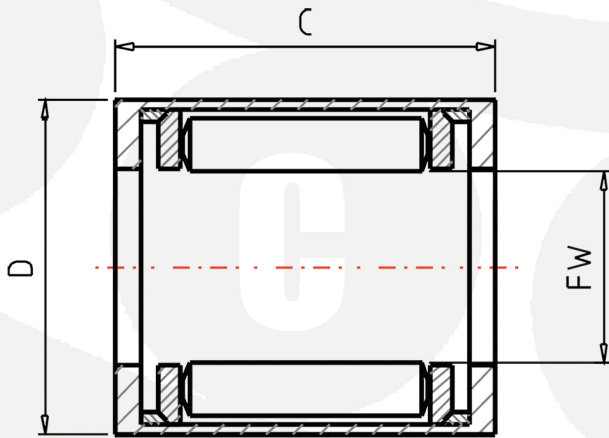

AISI52100 chrome Steel

FW Inscribed circle diameter	6.350	mm
D Outer Diameter	11.112	mm
C Width	12.70	mm
TC Torque Capacities	1.96	Nm
TC1 Torque Capacities	0.20	
MASS Mass	3.6	g
MODH Minimum Outside Diameters of Housing	16	mm
BGR1 Assembled Bearings (F.N.FH.BH)	B-45	
BGR2 Assembled Bearings (F.J.J.FJH.JH)	J-45	