

## OWC-GXZ series

### One-way Clutch with Stainless Steel Springs

**Part Number: OWC612GXRZ**

**Size: 6 x 12 x 5.4 mm**

*Locks when the shaft is rotated in the **Clockwise** direction.*

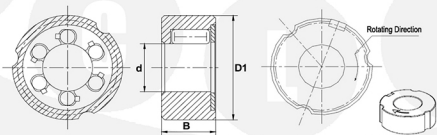

#### Part No.: OWC612GXRZ

Standards	Metric Size
Bearing Type	One-way Clutch
Rotation Direction	Clockwise Direction (RZ)
Bore Diameter (d)	6 mm
Outside Diameter (D1)	12 mm
Width (B)	5.4 mm
Operating Temperature (°C)	0 ~ 60
Free Rotating Torque	< 3 N/m
Rated Torque	0.80 N/m
Number of Rows	1 row
Number of Rollers	6 pieces
Precision Rating	ABEC-1
Outer Ring Material	Sintered Iron (Powder Metallurgy)
Roller Material	AISI52100
Spring Material	Stainless Steel
Closure Type & Material	Steel Shielded
Weight	2.75 g
Brand	Neutral / CLI