

# One Way Clutch Bearing

Part Number: **RC-121610** with plastic springs

0.7500 x 1.0000 x 0.6250 inch

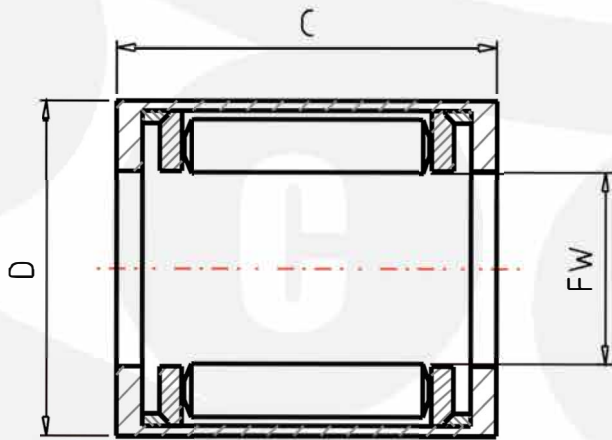

**AISI52100 chrome Steel**

FW Inscribed circle diameter	19.050	mm
D Outer Diameter	25.400	mm
C Width	15.88	mm
TC Torque Capacities	22.06	Nm
TC1 Torque Capacities	2.25	
MASS Mass	15.0	g
MODH Minimum Outside Diameters of Housing	36	mm
BGR1 Assembled Bearings (FN FH BH)	B-1210	
BGR2 Assembled Bearings (FJ J FJH JH)	J-1210	